

Proposed new Right of Way

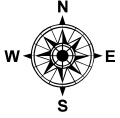

1.42

2.63

0.60

0.66

The Right of Way is 4m wide and follows a line between existing gates

WD470F

WD12169F

0.53

WD19550F

0.46

0.36

0.86

0.95

1.53

1.15

0.31

0.41

WD470F

WD470F

1:2,500

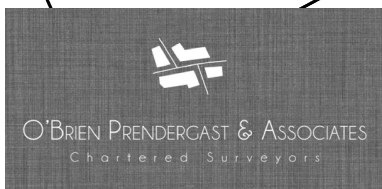
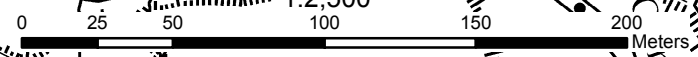

O'BRIEN PRENDERCAST & ASSOCIATES
Chartered Surveyors